

North.
South.

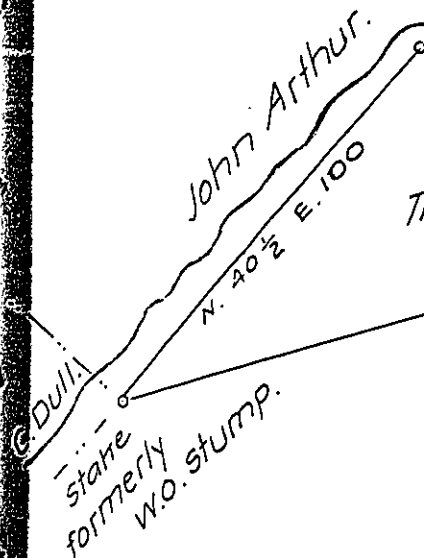

Bedford County
Andrew Buzzard &
John Devore
221a. & allow^e

Pat. Feb 24 - 1874 to
J. J. Habitzel et al
#72-560

No. 444.

A Dra
and Court
fourteen p
veyed the
to Allen B
pany, dat

To Hon. H
Secret

IN TESTIM